

WINTEC

QINGDAO WINTEC SYSTEM CO., LTD.

Wintec Park, Xinye Road, High-Tech Zone,
Qingdao, China

www.wintec.co

Anypos660

User Manual

Table of contents

Table of contents	3
Introduction	3
Product description	3
Product features	3
Specification	4
Product Usage	6
Packing list	6
Product appearance	6
I/O ports	7
Device Installation	11
General operations	15
Operating System	15
Common Configuration	15
Hardware-Software Integration	16
Troubleshooting	18
Revision sheet	19

Introduction

Product description

Anypos660, as the main model for the high-end market, focuses on the characteristics of beautiful and atmospheric modeling, stable and strong performance, flexible and convenient to use, the whole machine can also realize the screen high and low conditions, perfect fit for external printers, the sub-screen quickly plugged in the installation of a variety of hidden skills points, the main services at home and abroad in the flagship store of the brand, gas stations, high-end restaurants, hotels, and other high-end chain of customers, to explore the new possibilities of intelligent POS new possibilities.

Product features

- Family-oriented design language: using the design language of WINTEC's new product PI, following the family-oriented design of multi-category products, the whole machine is beautiful and atmospheric, with a high degree of recognition
- Free and Flexible Placement: Supports universal VESA bracket, wall-mounted, and pedestal bracket desktop placement for flexible and diverse use
- Ultra-narrow bezel design: Adopting a flat panel, narrow bezel industrial design, high screen-to-body ratio, more open vision, and a comprehensive upgrade of experience, bringing a light and smooth experience
- High-performance Configuration: Adopting Intel 11th generation CPU (supporting Tigerlake CPU (I3, I5) and Elkhartlake CPU), responsive and strong performance at the touch of a button
- Rich Interface Expansion: According to different usage scenarios, with different peripherals, for different host interfaces, Anypos660 provides a variety of interface combinations to choose the program
- More flexible interactive experience: according to the specific needs of the scene to choose 11.6-inch sub-screen, 15.6-inch sub-screen, the main and sub-screen can be selected to touch, customer service is more intuitive, member service is more intimate
- Rich peripheral expansion family: you can choose the integrated camera module (2D & 3D), IButton, MSR, fingerprint module, NFC module and so on according to the different expansion needs of customers, there is always a suitable one for you in the rich peripheral family

Specification

- Windows

Name	663A05	663A06	662A05	666A02	669A05	666A65	669A06
CPU	N97	N95	J6412	i5-1135G7	i3-1115G4	i5-1235U	i3-1215U
Memory	8GB DDR4, up to 16GB		8GB DDR4, up to 32GB	8GB DDR4, up to 64GB			
Storage	128GB M.2, up to 512GB						
Main display	15.6 inch,1366*768 / 1920*1080						
Main touch Screen	Multi point capacitive touch screen, USB interface						
Secondary display	a. 15.6 inch,1366*768 / 1920*1080 b. 11.6 inch,1366*768 / 1920*1080 c. No have						
Sub-touchscreen	Multi point capacitive touch screen, USB interface						
Speaker	Stereoscopic speaker, 1 * 5W						
WIFI	Dual frequency 2.4GHz/5GHz;BT4.0(optional)						
IO ports	4*USB 2*COM Port 1*Ethernet Port 1*Cash Drawer Port 1*HDMI port 1*DC_IN 1*AUDIO 1*12V DC_OUT						
Ethernet	10 / 100 / 1000M adaptive						
Temperature	Operating temperature: 0 - 40℃ Storage temperature: -20 - 55℃						
Humidity	Operating humidity: 20% - 95%RH Storage humidity: 20% - 95%RH						

● Android

Name	661C01	666C01
CPU	RK3568	RK3399
Memory	4GB	
Storage	32GB	
Main display	15.6 inch,1366*768 / 1920*1080	
Main touch Screen	Multi point capacitive touch screen, IIC interface	
Secondary display	a. 15.6 inch,1366*768/1920*1080 b. 11.6 inch,1366*768/1920*1080 c. No have	
Sub-touchscreen	Multi point capacitive touch screen, USB interface	
Speaker	Stereoscopic speaker, 1 * 5W	
WIFI	Dual frequency 2.4GHz/5GHz;BT4.0	
IO ports	4*USB 2*COM port 1*Ethernet port 1*Cash drawer port 1*DC_IN 1*HDMI port 1*OTG port 1*AUDIO 1*12V DC_OUT	
Ethernet	10/100/1000M adaptive	
Temperature	Operating temperature: 0 - 40℃ Storage temperature: -20 - 55℃	
Humidity	Operating humidity: 20% - 95%RH Storage humidity: 20% - 95%RH	

Product Usage

Packing list



POS host

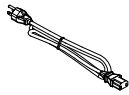

Power cable



Certificate of quality



Screw



Adapter

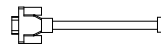

Serial port cable

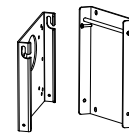

Wall mount (optional)

Content	Quantity
POS host	1
Power cable	1
Adapter	1
Certificate of quality	1
Serial port cable	1
Desktop bracket	1
Screw	1
Wall mount	1

Product appearance

Front View

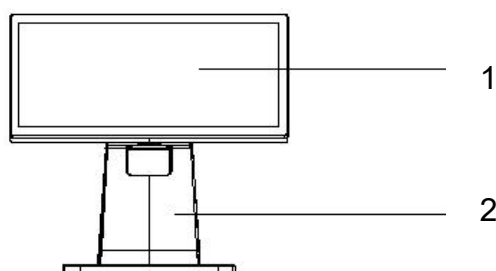

Number	Description
1	Main display
2	Base

Back View

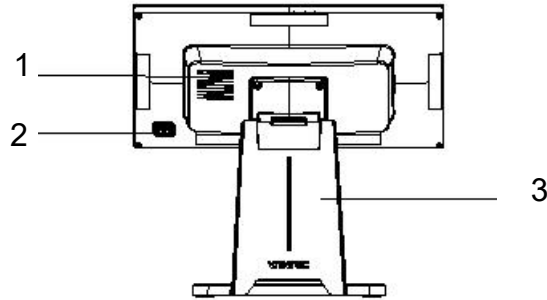

Number	Description
1	Speaker
2	Power button
3	Magnetic back cover

I/O ports

Old type:(Before 9/2024)

Standard configuration IO

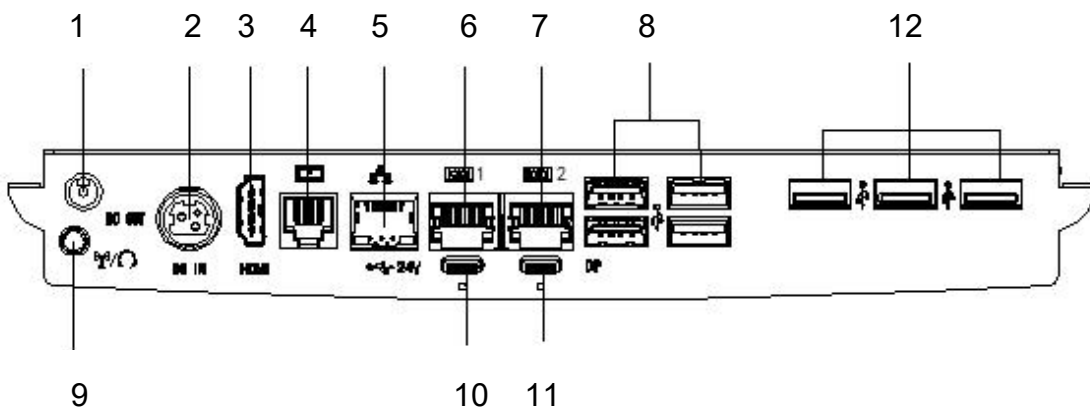

Optional I/O ports ①

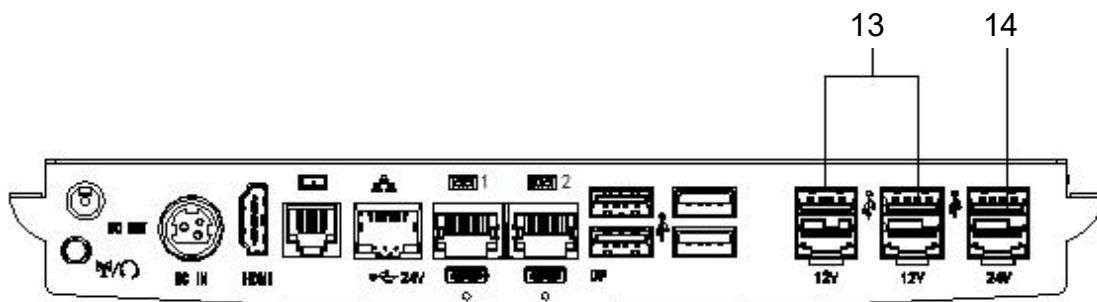

Optional I/O ports ②

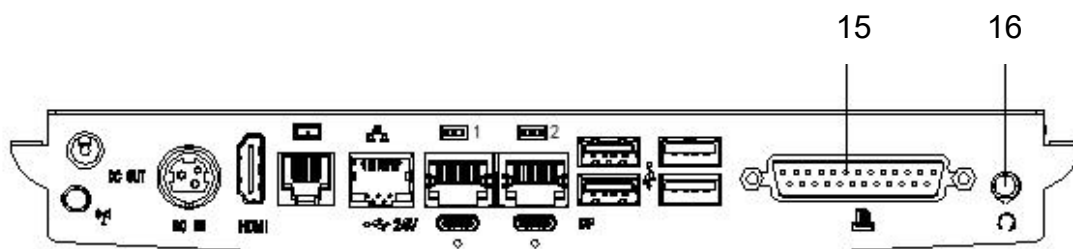

Optional I/O ports ③

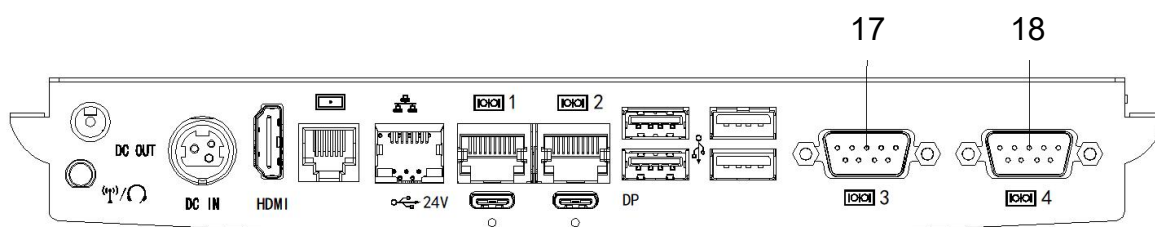

Optional I/O ports ④

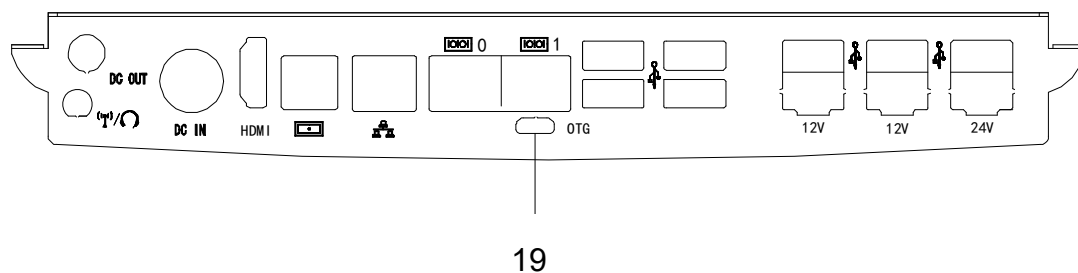

Number	Description
1	12V DC OUT
2	24V DC IN
3	HDMI port
4	Cash drawer port
5	Ethernet port
6	COM1 port (5V)
7	COM2 port (5V)
8	USB port
9	Antenna / Headphones port
10	Type C USB port
11	DP port
12	USB port
13	12V Powered USB port
14	24V Powered USB port
15	LPT port
16	Headphones port
17	COM3 port (5V)
18	COM4 port (5V)
19	OTG port

New type(After 9/2024)

Standard configuration IO

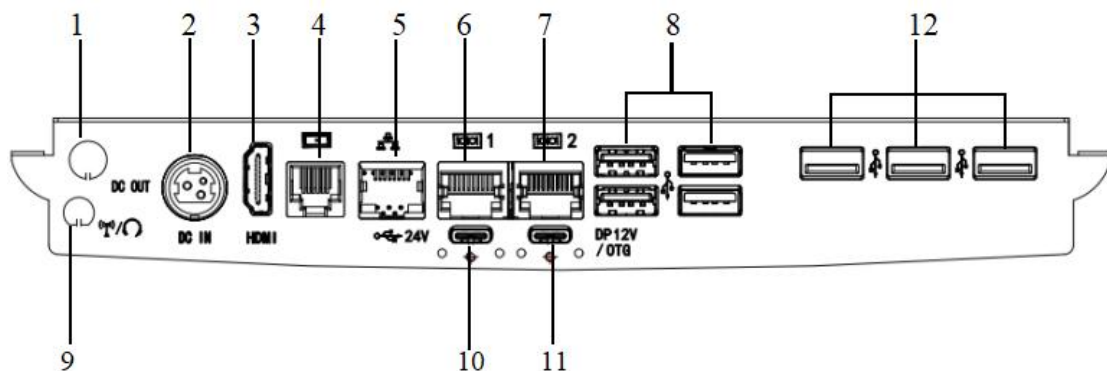

Number	Description
1	12V DC OUT
2	24V DC IN
3	HDMI port
4	Cash drawer port
5	Ethernet port
6	Windows:COM1 port (5V) Android:COM0 port (5V)
7	Windows:COM2 port (5V) Android:COM1 port (5V)
8	USB port
9	Antenna / Headphones port
10	Windows:Type C USB port Android:No have
11	Windows:DP port Android:OTG port
12	USB port

Optional I/O ports ①

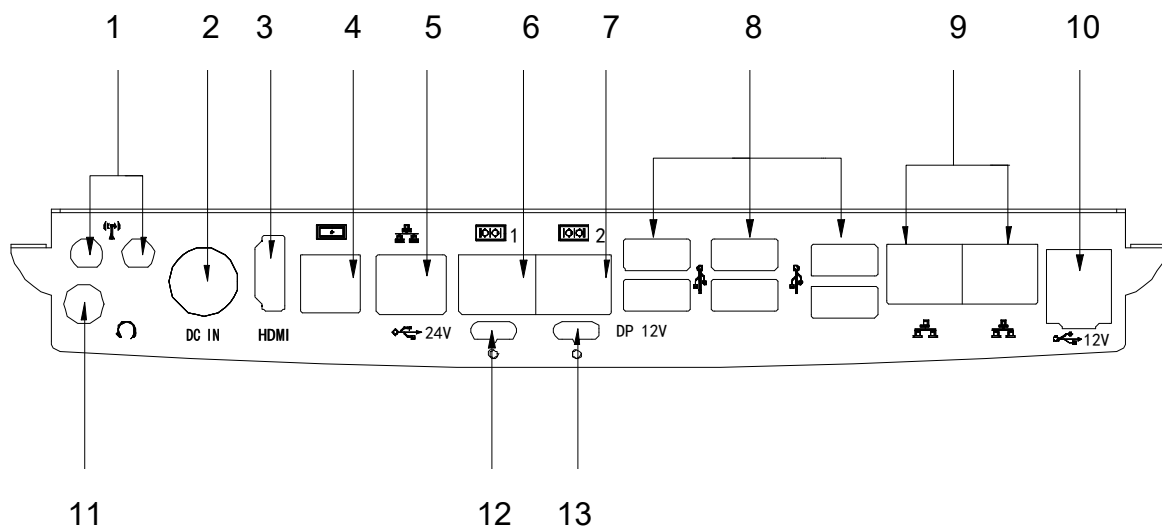

Number	Description
1	Antenna port

2	24V DC IN
3	HDMI port
4	Cash drawer port
5	Ethernet port
6	COM1 port (5V)
7	COM2 port (5V)
8	USB port
9	Ethernet port
10	12V Powered USB port
11	Headphones port
12	Type C USB port
13	DP port

Device Installation

Optional secondary panel components installation

1. Take out the sub-panel assembly in the packing box as shown in the following figure, and pay attention to the rubber cover (mark 1) to be placed in the position shown.

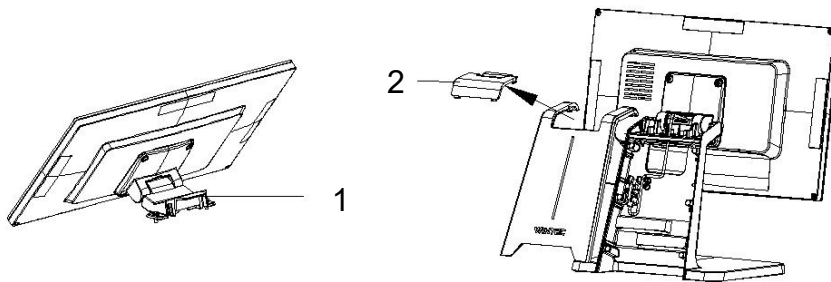

2. Remove the small cover plate (marked 2) located above the magnetic rear cover of the main unit, following the direction indicated by the arrow.
3. Install the secondary display onto the main unit in the direction indicated by the arrow in the diagram below. Tighten the screws and connect the cable via the Type-C port. Secure the connector to the base's retaining clips as shown in the enlarged section of the diagram. Finally, snap the secondary display cover plate (marked 1) into place to complete assembly of the secondary display assembly.

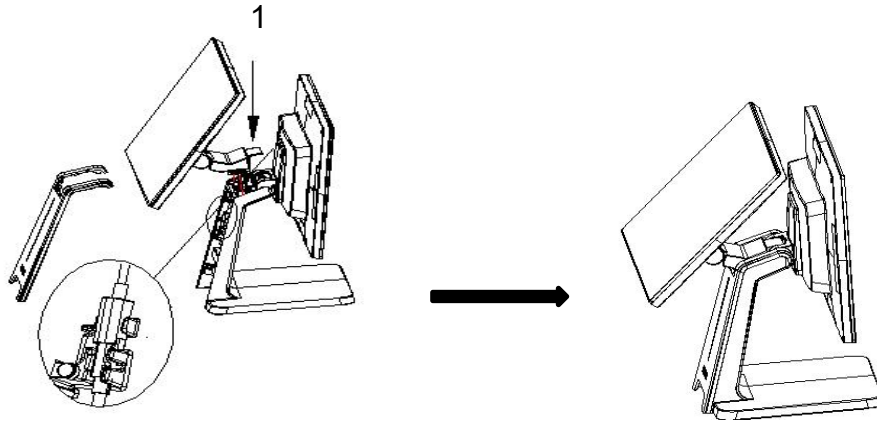

Replacement of secondary screen (replacement of 11.6-inch horizontal screen with 15.6-inch vertical screen)

1. Open the magnetic cover of the main unit and unplug the Type-C cable connected to the secondary screen.
2. Use a Phillips screwdriver to remove the four screws securing the secondary screen. See the image below:

Note: To better illustrate the steps for replacing the secondary screen, the main screen has been hidden in the images below.

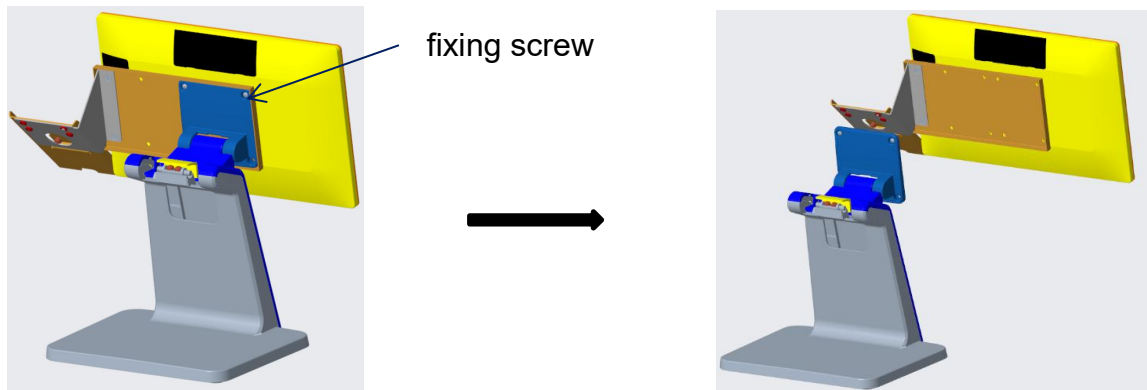

3. Thread the replacement sub-screen cable through the cable passage hole in the pinpad bracket, along the base bracket into the base column, with the sub-screen placed vertically. The sub-screen screw holes, the four screw holes on the left side of the pinpad bracket, and the base bracket screw holes must be aligned. Reinstall the screws removed in step 2. Finally, connect the Type-C port cable from the auxiliary screen in step 1 to its designated position.

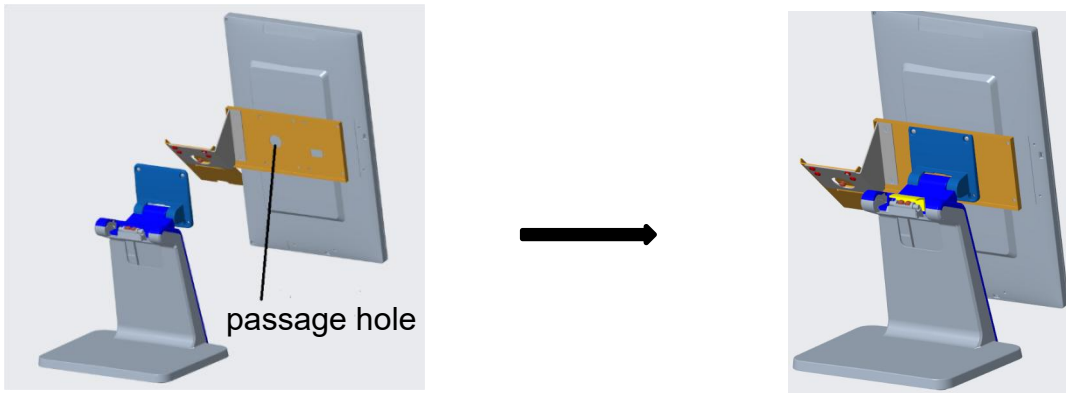

Optional MSR card reader assembly installation

4. Install the card reader on the right rear side of the main screen according to the figure, tighten it with screws according to the partial enlarged picture below, and then close the cover of the card reader.

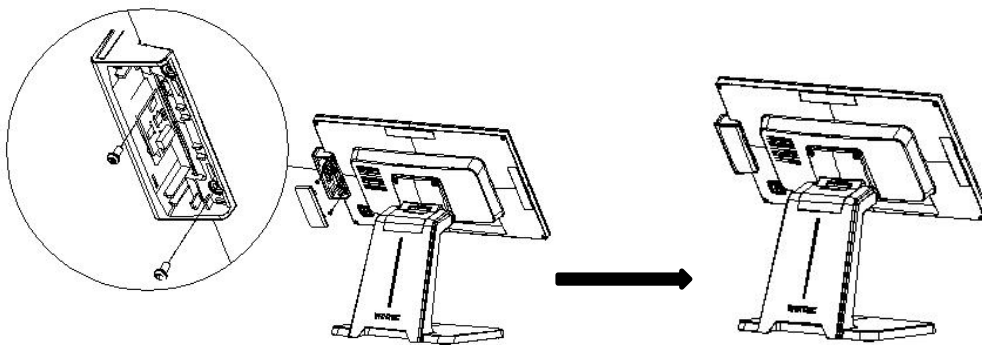

Cable management scheme

1. After removing the magnetic back cover.
2. Pass the cable to be plugged through the threading hole (mark 1) of the base and then plug it into the corresponding interface of the main unit.
3. Use the cable management buckle (mark 2) to organize the cables in an orderly manner.
4. Close the magnetic back cover to finish cable management.

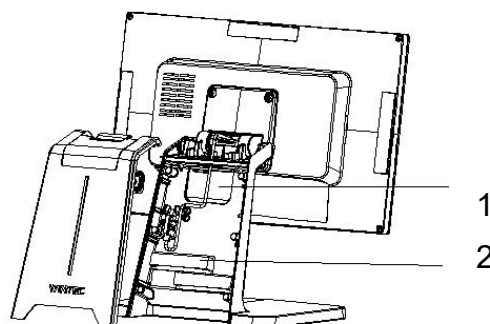

Wall mounted installation plan

1. Fix a part of the wall mounting bracket to the wall in the direction shown in the figure below using 4 expansion screws.

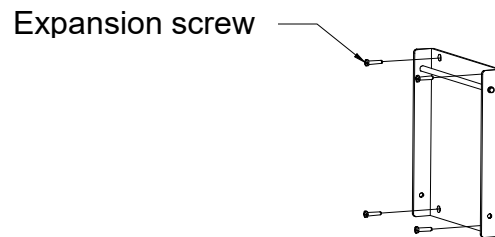

2. Fix the other part of the wall mounted bracket to the host in the direction shown in the following figure using 4 M4 * 8 screws.

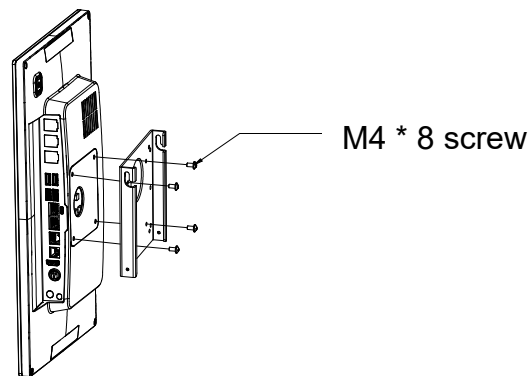

3. Connect the adapter and hang the host with a wall mounted bracket on another part of the wall mounted bracket, as shown in the following figure.

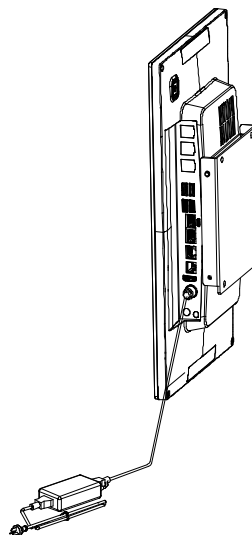

General operations

Power on

Android: Long press the switch button, hear the "drop" sound, let go, and wait for the boot.

Windows: Press the power button, release it, and wait for the power to turn on.

Power off

Android: Press and hold the switch button, and select the shutdown option in the pop-up dialog box to shut down the system.

Windows: Under the system, click the  button in the lower menu, select the shutdown option, and shut down the system.

Note: Do not turn off the power directly or pull out the power cable. This may cause damage to the device.

Operating System

663A05 / 669A05 / 666A02 / 662A05 / 666A06

- Windows

Peripherals	Port name	Parameters
MSR	USB	USB2.0

661C01

- Android

Peripherals	Port name	Parameters
MSR	USB	USB2.0

Common Configuration

Dual-screen configuration

1. When dual-screen device is configured with dual-screen expansion, the touch on the main screen will be fed back to the secondary screen, and the touch screen needs to be bound in the Control panel - Tablet Settings, as shown in the following figure:

2. Go to the Control Panel and find "Tablet Settings".

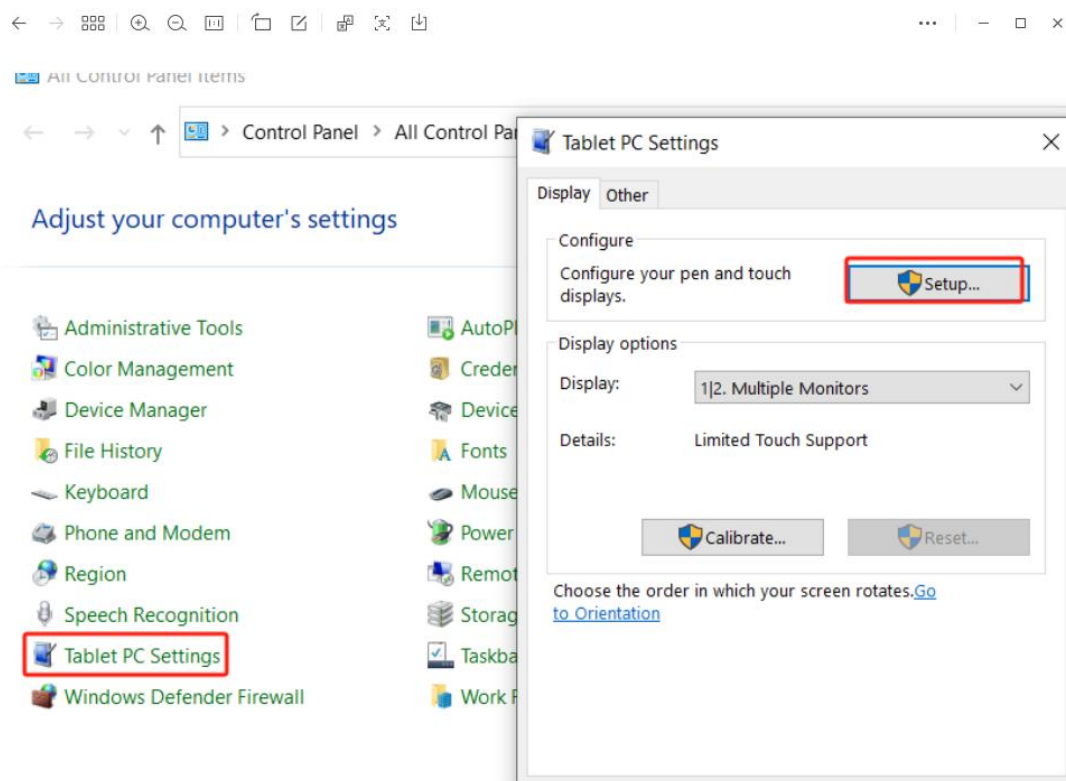

3. Click the "Settings" button in the "Display" TAB.

Tap this screen with a single finger to identify it as the touchscreen.

If this is not the Tablet PC screen, press Enter to move to the next screen. To close the tool, press Esc.

4. Switch the interface displayed at the top to the screen where the touch screen is located, and then tap the touch screen with your hand to bind the touch screen.

Hardware-Software Integration

663A05 / 669A05 / 666A02 / 662A05 / 666A06

File name	Description
-----------	-------------

Driver	The driver is stored in the Drivers folder on the D drive of your Windows system
--------	--

661C01

File name	Description
SDK interface description.docx	WINTEC SDK Interface Documentation
WINTEC_SDK.apk	Service Middleware WINTEC_SDK
WT-SDK.jar	Service middleware WT-SDK.jar package

Troubleshooting

If you are experiencing trouble with your device, refer to the following table. If the problem persists, please contact your local dealer or the WINTEC service center.

Issue	Recommended solutions
Device fails to power on	Turn off the power and check the DC power cord for proper connection.
No sound from the speaker	Install the audio driver and set the speaker output.
System non-response	Restart the device or unplug and plug in the power supply to restart the device.

Revision sheet

Version	Change description	Author
1.0.0	Initial Release	Wenjie Li
1.0.1	Add N95 / i3-1215U / RK3399 Configuration	Wenjie Li
1.0.2	Add I/O ports configuration	Wenjie Li
1.0.3	Add I/O ports configuration Add secondary screen replacement	Wenjie Li